

MULTI-JET WATER METER



Overview

It is a multi-jet dry type water meter for residential application in sizes 15mm-50mm for cold / hot water.

Features

- Magnetic Drive, Lower transmission resistance.
 - Magnetic shield, for external magnetic field protection.
 - Sealed dry register ensures long time clear reading.
 - External regulating device.
 - Register sealed type: Dry type; Semi-dry type; Super-dry type.
 - Accuracy: Class B.
 - Size: 15~50mm.
 - Cold / hot water.
 - Non return valve.
 - Reed switch option.
 - Several lengths and connections available on request.
 - Thread end type: BSP / NPT.
- Accessories: 2pcs coupling, 2pcs coupling nuts and 2pcs washers.

Working Conditions

- Water temperature: 0.1 °C ~ 50 °C for cold water meter.
- 0.1 °C ~ 90 °C for hot water meter.
- Water pressure: ≤16bar for brass body
≤10bar for plastic body

Maximum Permissible Error

- In the lower zone from q_1 inclusive up to but excluding q_2 is $\pm 5\%$.
- In the upper zone from q_2 inclusive up to and including q_4 is $\pm 2\%$; $\pm 3\%$ for hot water meter.

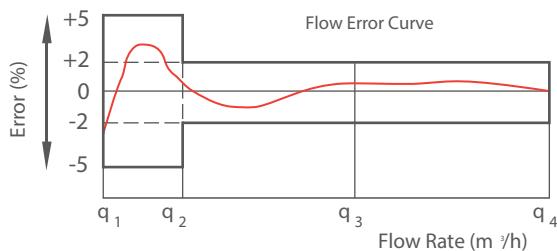

Standards Compliance

Technical data conform to international standard ISO 4064.

Overall Dimension And Weight

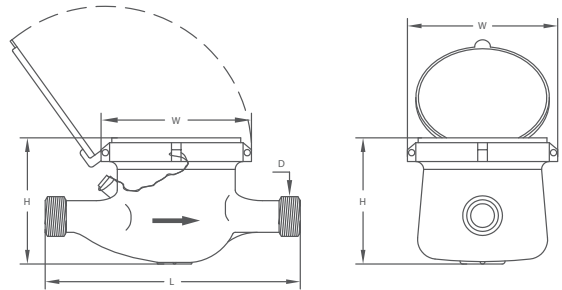

DN (mm)	15	20	25	32	40	50	50
Size (inch)	1/2"	3/4"	1"	1-1/4"	1-1/2"	2"	2"
Length (L)	165/190	190	260	260	300	300	280
Width (W)	98	98	103.5	103.5	125	125	160
Height (H)	116	117	124	124	162	162	187.5
Connecting Thread D	G3/4B	G1B	G1 1/4B	G1 1/2B	G2B	G2 1/2B	Flange end

Technical Data

Nominal Diameter (mm)	15	20	25	32	40	50
Size (inch)	1/2"	3/4"	1"	1-1/4"	1-1/2"	2"
Class	B					
Qs(m³/h)	3	5	7	12	20	30
Qp(m³/h)	1.5	2.5	3.5	6.0	10	15
Qt (l/h)	120	200	280.0	480	800	3000
Qmin (l/h)	30	50	70	120	200	450
Max. Reading (m3)	99,999	99,999	99,999	99,999	99,999	99,999
Min. Reading (Liter)	0.05	0.05	0.05	0.05	0.05	0.05
Accuracy Class	Class2					
Temperature Class	T50/T90					
Maximum Admissible Pressure	PN16					
Pressure Loss Classes	0.63bar					
Pulse Output Option	Vmax=24V					
	Imax=100mA					
	Pmax=2W					